

WINGBURG

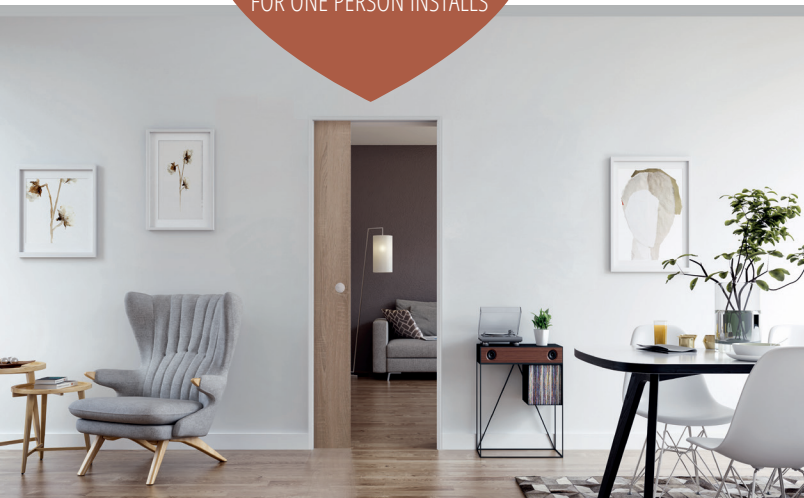

**QUICK AND
VERSATILE**

ADJUSTABLE FRAME AND TRACK
FOR ONE PERSON INSTALLS



HANNOVER

Pocket door track and framing kit

SKUS AND ACCESSORIES



Door thickness: 1-3/8" to 1-3/4" wood; 3/8" and 1/2" frameless glass
Studwork: 2x4 wood or 3 5/8" metal
Load capacity: 176 to 265 lb
Set includes: Extruded aluminum track; ball bearing carriages; hold-in-place, soft-close or push-to-open end stops; basic or recessed mounting hardware for wood or clamps for frameless glass panels; floor guides for either application; pocket framing kit made from extruded aluminum; compression clamps

40" - Standard Wood Sets

W-PK40-1WS00	HANNOVER for doors up to 40x96", standard wood mounts and hold-in-place stoppers
W-PK40-1WS01	HANNOVER for doors up to 40x96", standard wood mounts, 1 hold-in-place stopper and 1 Soft-Close
W-PK40-1WS02	HANNOVER for doors up to 40x96", standard wood mounts and 2 Soft-Close
W-PK40-1WS03	HANNOVER for doors up to 40x96", standard wood mounts, 1 hold-in-place stopper and 1 Push-To-Open
W-PK40-1WS04	HANNOVER for doors up to 40x96", standard wood mounts, 1 Soft-Close and 1 Push-To-Open
W-PK40-1WS05	HANNOVER for doors up to 40x96", standard wood mounts, hold-in-place stoppers and 265 lb carriages
W-PK40-2WS06	2x HANNOVER for doors up to 40x96", standard wood mounts, hold-in-place stoppers and a Sync for bi-parting doors

40" - Recessed Wood Mount Sets

W-PK40-1WR00	HANNOVER for doors up to 40x96", recessed wood mounts and hold-in-place stoppers
W-PK40-1WR01	HANNOVER for doors up to 40x96", recessed wood mounts, 1 hold-in-place stopper and 1 Soft-Close
W-PK40-1WR02	HANNOVER for doors up to 40x96", recessed wood mounts and 2 Soft-Close
W-PK40-1WR03	HANNOVER for doors up to 40x96", recessed wood mounts, 1 hold-in-place stopper and 1 Push-To-Open
W-PK40-1WR04	HANNOVER for doors up to 40x96", recessed wood mounts, 1 Soft-Close and 1 Push-To-Open
W-PK40-1WR05	HANNOVER for doors up to 40x96", recessed wood mounts, hold-in-place stoppers and 265 lb carriages

40" - Glass Clamps With Valance Sets

W-PK40-1GV00	HANNOVER for doors up to 40x96", glass clamps with stainless steel look valance and hold-in-place stoppers
W-PK40-1GV01	HANNOVER for doors up to 40x96", glass clamps with stainless steel look valance, 1 hold-in-place stopper and 1 Soft-Close
W-PK40-1GV02	HANNOVER for doors up to 40x96", glass clamps with stainless steel look valance and 2 Soft-Close
W-PK40-1GV03	HANNOVER for doors up to 40x96", glass clamps with stainless steel look valance, 1 hold-in-place stopper and 1 Push-To-Open
W-PK40-1GV04	HANNOVER for doors up to 40x96", glass clamps with stainless steel look valance, 1 Soft-Close and 1 Push-To-Open
W-PK40-1GV05	HANNOVER for doors up to 40x96", glass clamps with stainless steel look valance, hold-in-place stoppers and 265 lb carriages

48" - Standard Wood Sets

W-PK48-1WS00	HANNOVER for doors up to 48x96", standard wood mounts and hold-in-place stoppers
W-PK48-1WS01	HANNOVER for doors up to 48x96", standard wood mounts, 1 hold-in-place stopper and 1 Soft-Close
W-PK48-1WS02	HANNOVER for doors up to 48x96", standard wood mounts and 2 Soft-Close
W-PK48-1WS03	HANNOVER for doors up to 48x96", standard wood mounts, 1 hold-in-place stopper and 1 Push-To-Open
W-PK48-1WS04	HANNOVER for doors up to 48x96", standard wood mounts, 1 Soft-Close and 1 Push-To-Open
W-PK48-1WS05	HANNOVER for doors up to 48x96", standard wood mounts, hold-in-place stoppers and 265 lb carriages
W-PK48-2WS06	2x HANNOVER for doors up to 48x96", standard wood mounts, hold-in-place stoppers and a Sync for bi-parting doors

48" - Recessed Wood Mount Sets

W-PK48-1WR00	HANNOVER for doors up to 48x96", recessed wood mounts and hold-in-place stoppers
W-PK48-1WR01	HANNOVER for doors up to 48x96", recessed wood mounts, 1 hold-in-place stopper and 1 Soft-Close
W-PK48-1WR02	HANNOVER for doors up to 48x96", recessed wood mounts and 2 Soft-Close
W-PK48-1WR03	HANNOVER for doors up to 48x96", recessed wood mounts, 1 hold-in-place stopper and 1 Push-To-Open
W-PK48-1WR04	HANNOVER for doors up to 48x96", recessed wood mounts, 1 Soft-Close and 1 Push-To-Open
W-PK48-1WR05	HANNOVER for doors up to 48x96", recessed wood mounts, hold-in-place stoppers and 265 lb carriages

48" - Glass Clamps With Valance Sets

W-PK48-1GV00	HANNOVER for doors up to 48x96", glass clamps with stainless steel look valance and hold-in-place stoppers
W-PK48-1GV01	HANNOVER for doors up to 48x96", glass clamps with stainless steel look valance, 1 hold-in-place stopper and 1 Soft-Close
W-PK48-1GV02	HANNOVER for doors up to 48x96", glass clamps with stainless steel look valance and 2 Soft-Close
W-PK48-1GV03	HANNOVER for doors up to 48x96", glass clamps with stainless steel look valance, 1 hold-in-place stopper and 1 Push-To-Open
W-PK48-1GV04	HANNOVER for doors up to 48x96", glass clamps with stainless steel look valance, 1 Soft-Close and 1 Push-To-Open
W-PK48-1GV05	HANNOVER for doors up to 48x96", glass clamps with stainless steel look valance, hold-in-place stoppers and 265 lb carriages

Accessories

W-PK00-9WG01	Soft Close (single), max. 176 lb, min. 24" door width
W-PK00-9WG02	Soft Close (double), max. 176 lb, min. 34" door width
W-PK00-9WG03	Push To Open, max. 176 lb, min. 24" door width (26" with pocket side Soft Close)
W-PK00-9WG05	Upgraded Wheels, max. 265 lb
W-PK00-9WG06	Sync, for biparting wood doors (basic mount only), max. 176 lb per panel
W-PK00-9WR00	Recessed Wood Door Mount, max. 265 lb
W-PK00-9GV00	Glass Clamps with stainless steel look valance, max. 265 lb, 3/8" and 1/2" glass



ROUGH OPENING GUIDE

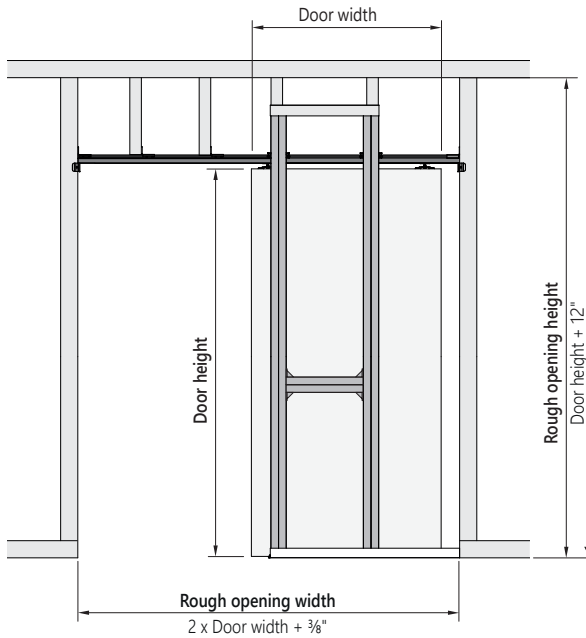

Door width	Door height							
	80"		82"		84"		96"	
	RO width	RO height	RO width	RO height	RO width	RO height	RO width	RO height
24"	48 3/8"	92"	48 3/8"	94"	48 3/8"	96"	48 3/8"	108"
26"	52 3/8"	92"	52 3/8"	94"	52 3/8"	96"	52 3/8"	108"
28"	56 3/8"	92"	56 3/8"	94"	56 3/8"	96"	56 3/8"	108"
30"	60 3/8"	92"	60 3/8"	94"	60 3/8"	96"	60 3/8"	108"
32"	64 3/8"	92"	64 3/8"	94"	64 3/8"	96"	64 3/8"	108"
34"	68 3/8"	92"	68 3/8"	94"	68 3/8"	96"	68 3/8"	108"
36"	72 3/8"	92"	72 3/8"	94"	72 3/8"	96"	72 3/8"	108"
38"	76 3/8"	92"	76 3/8"	94"	76 3/8"	96"	76 3/8"	108"
40"	80 3/8"	92"	80 3/8"	94"	80 3/8"	96"	80 3/8"	108"
42"	84 3/8"	92"	84 3/8"	94"	84 3/8"	96"	84 3/8"	108"
44"	88 3/8"	92"	88 3/8"	94"	88 3/8"	96"	88 3/8"	108"
46"	92 3/8"	92"	92 3/8"	94"	92 3/8"	96"	92 3/8"	108"
48"	96 3/8"	92"	96 3/8"	94"	96 3/8"	96"	96 3/8"	108"

* Minimum required rough opening height. If you have enough headroom, you can install the pocket door without cutting the vertical pocket profiles. This requires a rough opening height of 108" or more.

ROUGH OPENING GUIDE - BIPARTING DOORS

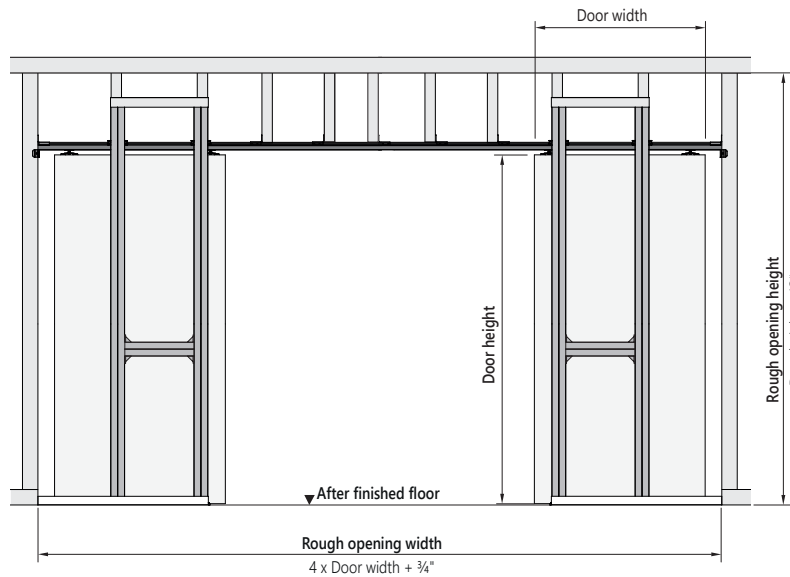

Door width	Door height							
	80"		82"		84"		96"	
	RO width	RO height	RO width	RO height	RO width	RO height	RO width	RO height
24"	96 3/4"	92"	96 3/4"	94"	96 3/4"	96"	96 3/4"	108"
26"	104 3/4"	92"	104 3/4"	94"	104 3/4"	96"	104 3/4"	108"
28"	112 3/4"	92"	112 3/4"	94"	112 3/4"	96"	112 3/4"	108"
30"	120 3/4"	92"	120 3/4"	94"	120 3/4"	96"	120 3/4"	108"
32"	128 3/4"	92"	128 3/4"	94"	128 3/4"	96"	128 3/4"	108"
34"	136 3/4"	92"	136 3/4"	94"	136 3/4"	96"	136 3/4"	108"
36"	144 3/4"	92"	144 3/4"	94"	144 3/4"	96"	144 3/4"	108"
38"	152 3/4"	92"	152 3/4"	94"	152 3/4"	96"	152 3/4"	108"
40"	160 3/4"	92"	160 3/4"	94"	160 3/4"	96"	160 3/4"	108"
42"	168 3/4"	92"	168 3/4"	94"	168 3/4"	96"	168 3/4"	108"
44"	176 3/4"	92"	176 3/4"	94"	176 3/4"	96"	176 3/4"	108"
46"	184 3/4"	92"	184 3/4"	94"	184 3/4"	96"	184 3/4"	108"
48"	192 3/4"	92"	192 3/4"	94"	192 3/4"	96"	192 3/4"	108"

* Minimum required rough opening height. If you have enough headroom, you can install the pocket door without cutting the vertical pocket profiles. This requires a rough opening height of 108" or more.

DOOR MOUNT OPTIONS



WOOD BASIC

WOOD RECESSED

GLASS CLAMPS

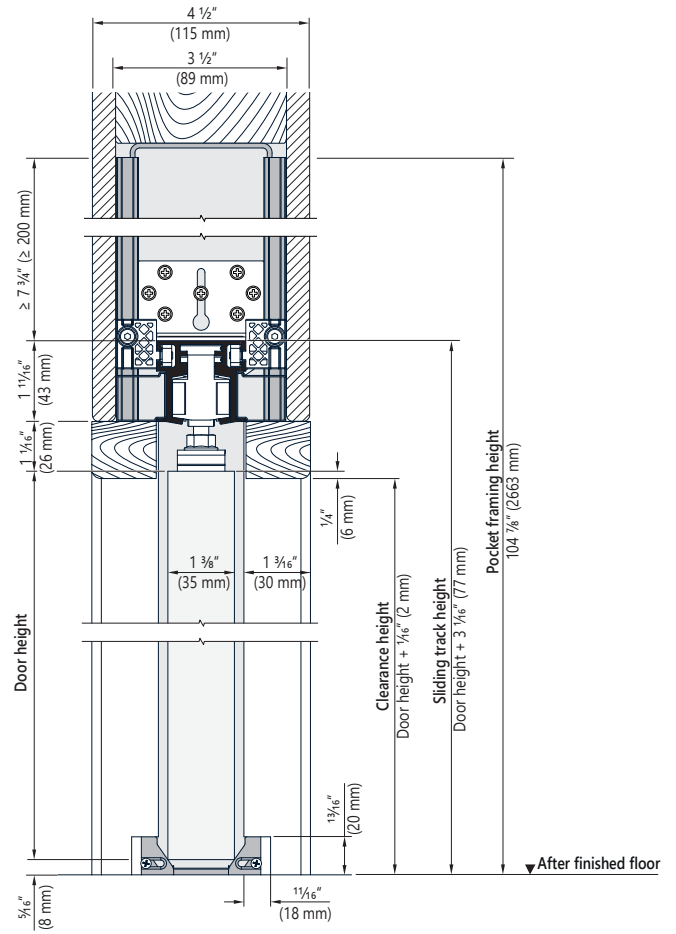
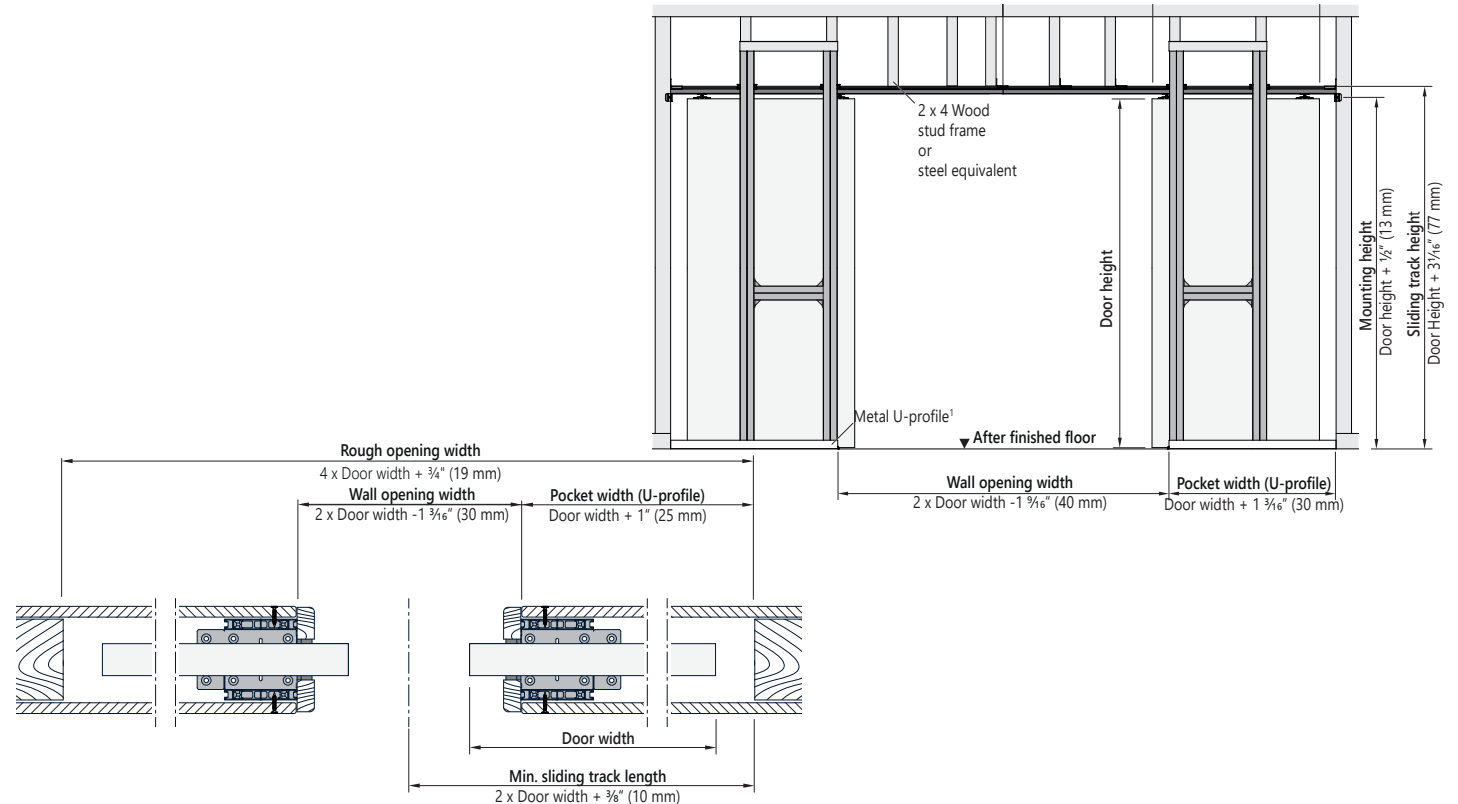
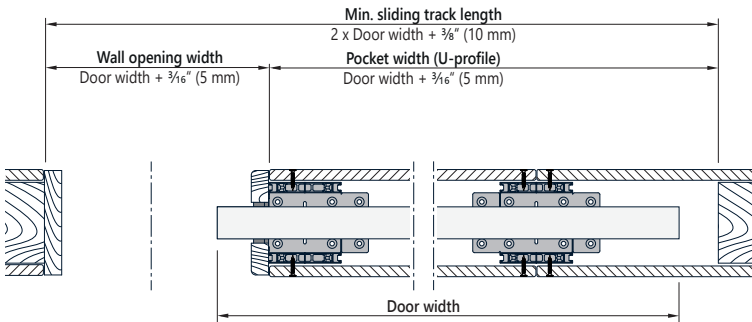
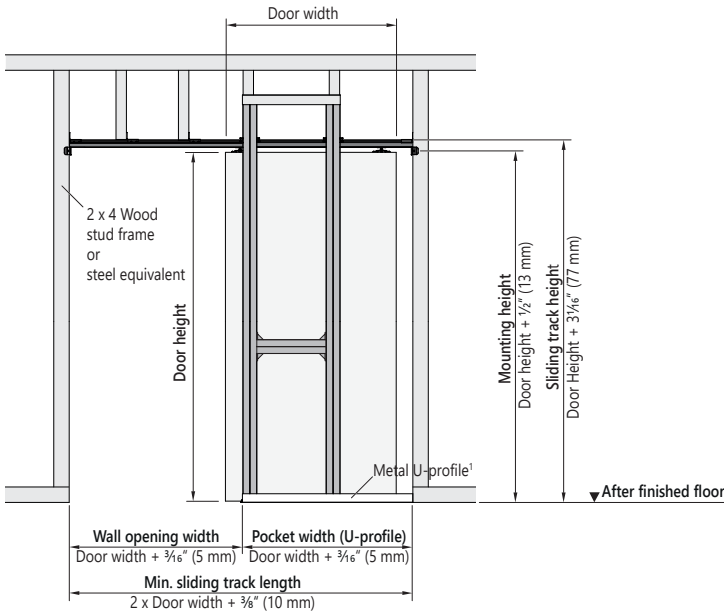

DOOR MOUNT OPTIONS



WOOD BASIC

WOOD RECESSED

GLASS CLAMPS

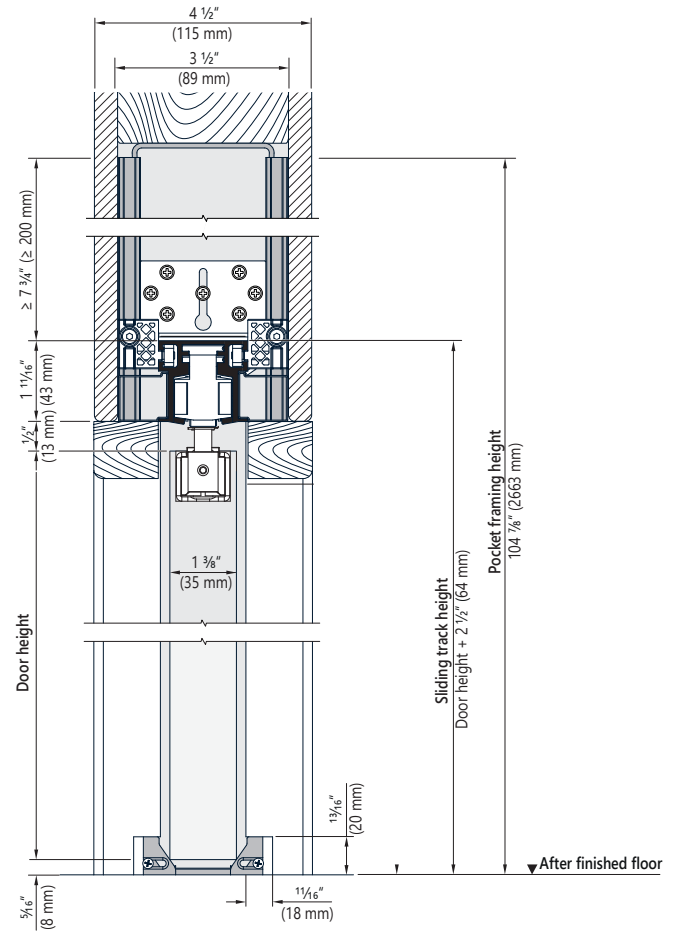
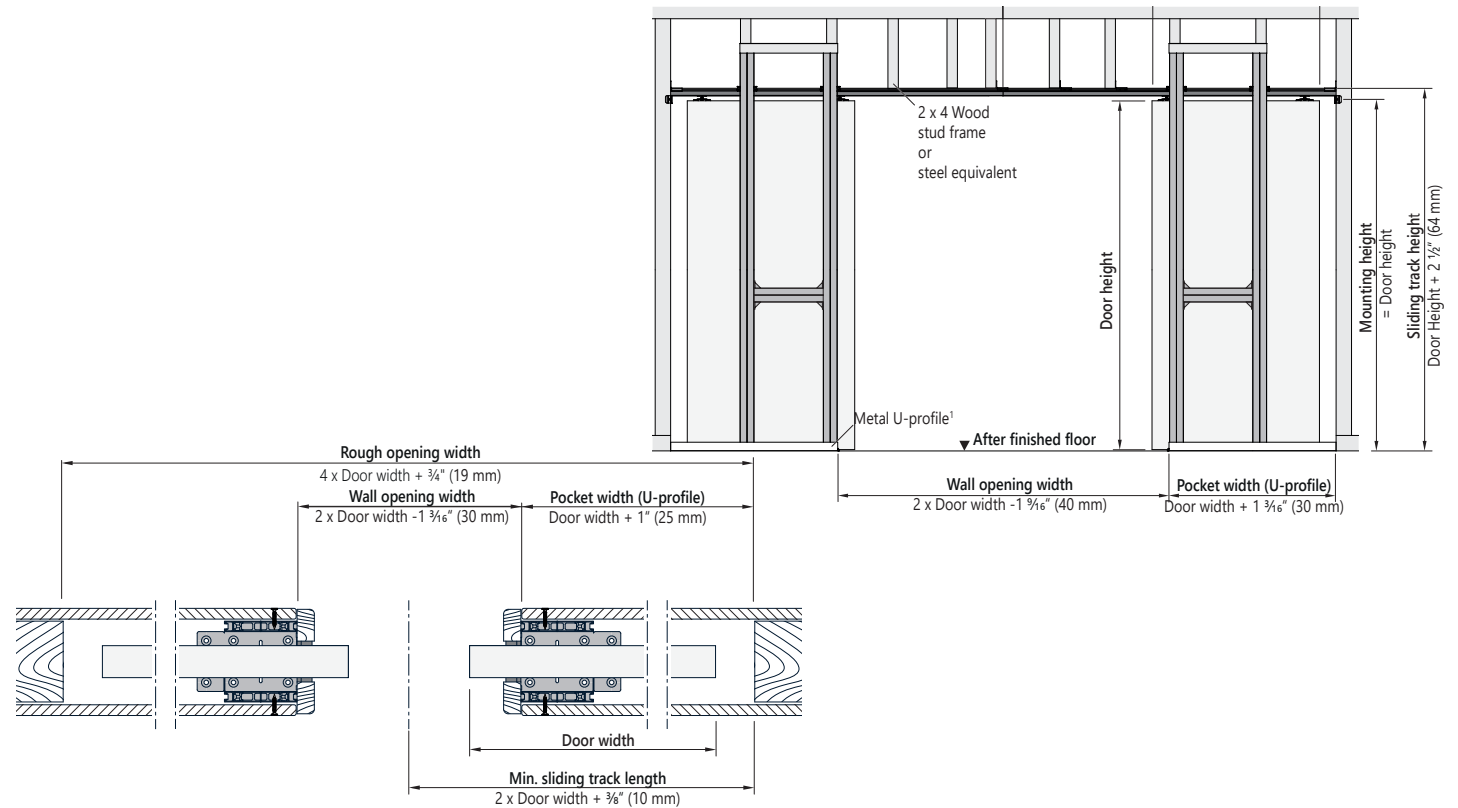
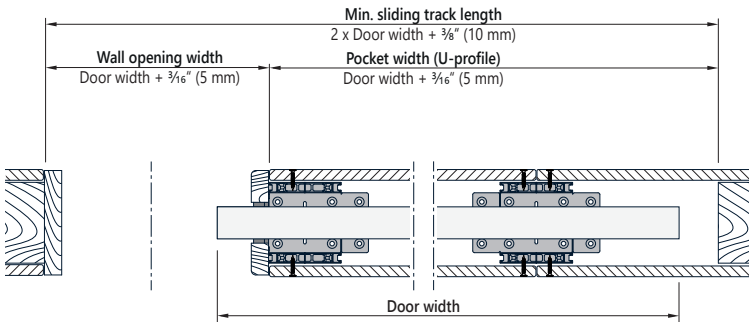
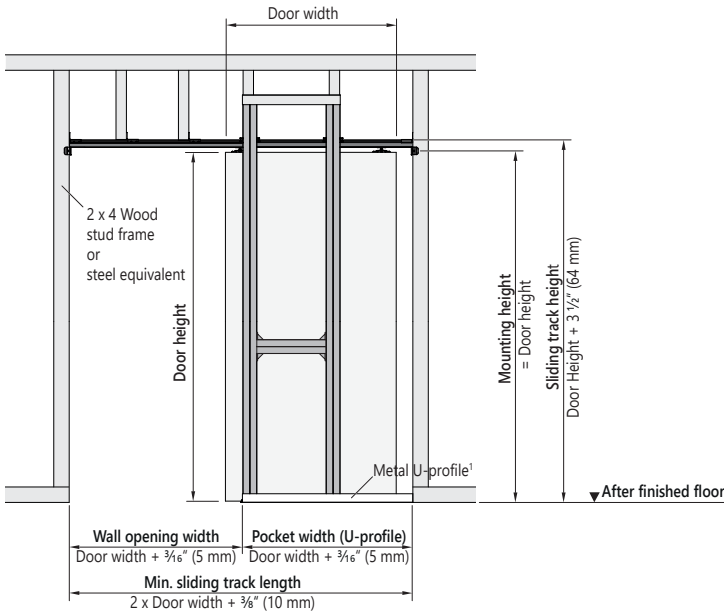

DOOR MOUNT OPTIONS



WOOD BASIC

WOOD RECESSED

GLASS CLAMPS

