

# INSTALLATION INSTRUCTION

## SLIDING DOOR HARDWARE *HERRAJES PARA PUERTAS CORREDERAS*

Sync (bi-parting)  
for double wood sliding doors  
up to 176 lb (80 kg) per panel

*Sync (bipartición) para puertas  
correderas dobles de madera  
hasta 176lb (80 kg) por panel*

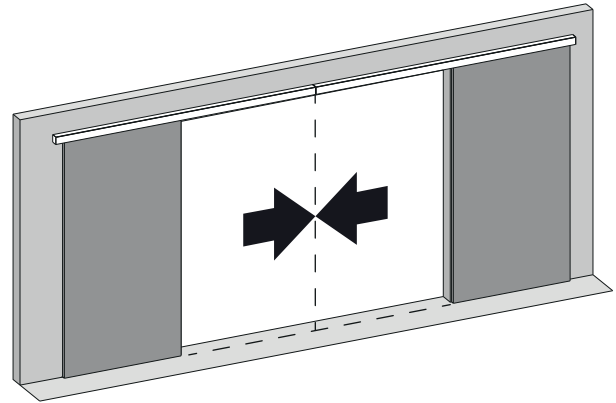

**i**

2x

**a**

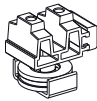

M5 x 30

2x

**b**



M5 x 35

2x

**c**

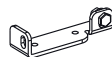

1x

**d**

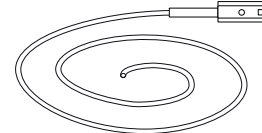

# INSTALLATION INSTRUCTION

## SLIDING DOOR HARDWARE *HERRAJES PARA PUERTAS CORREDERAS*

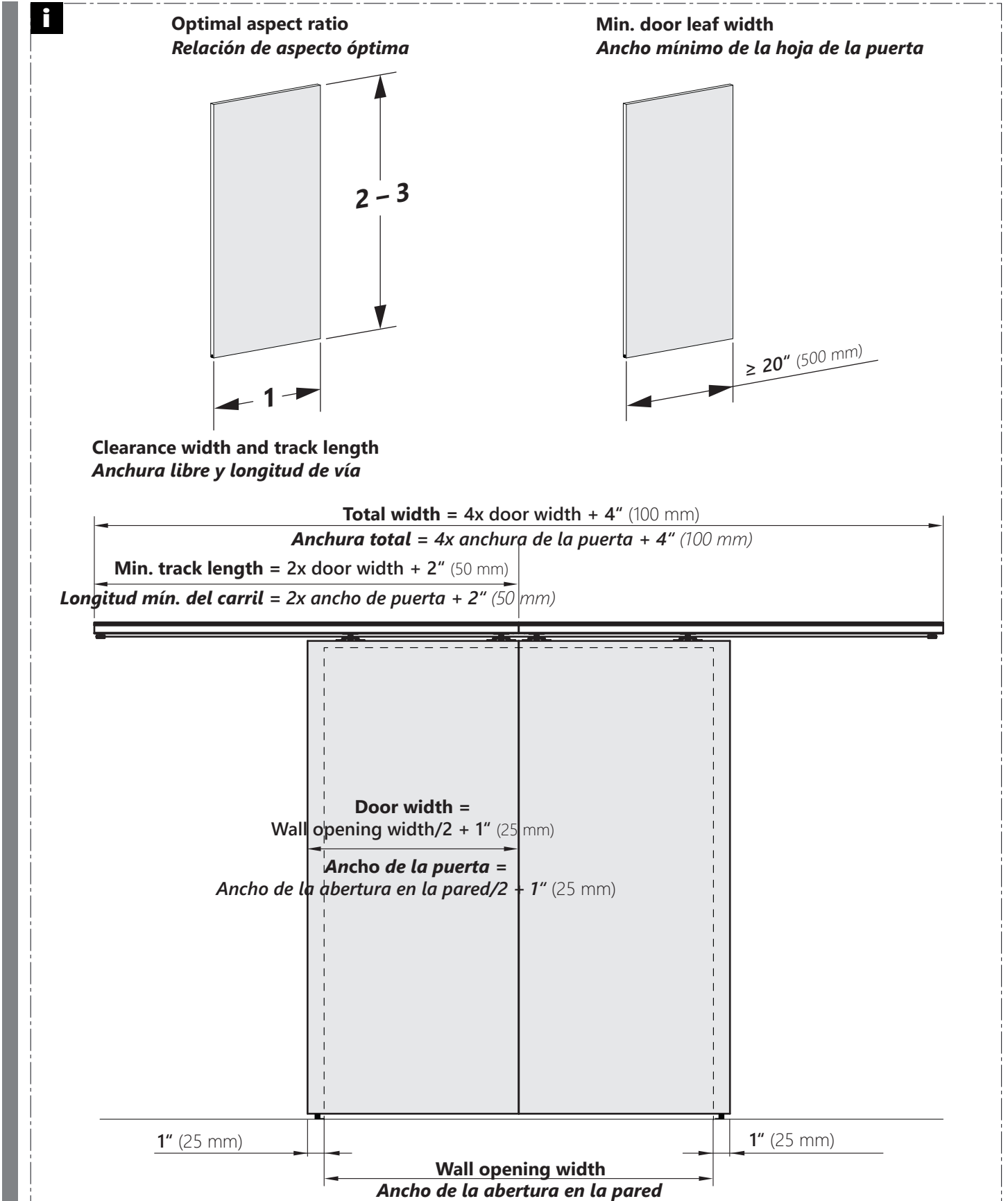

# INSTALLATION INSTRUCTION

## SLIDING DOOR HARDWARE *HERRAJES PARA PUERTAS CORREDERAS*

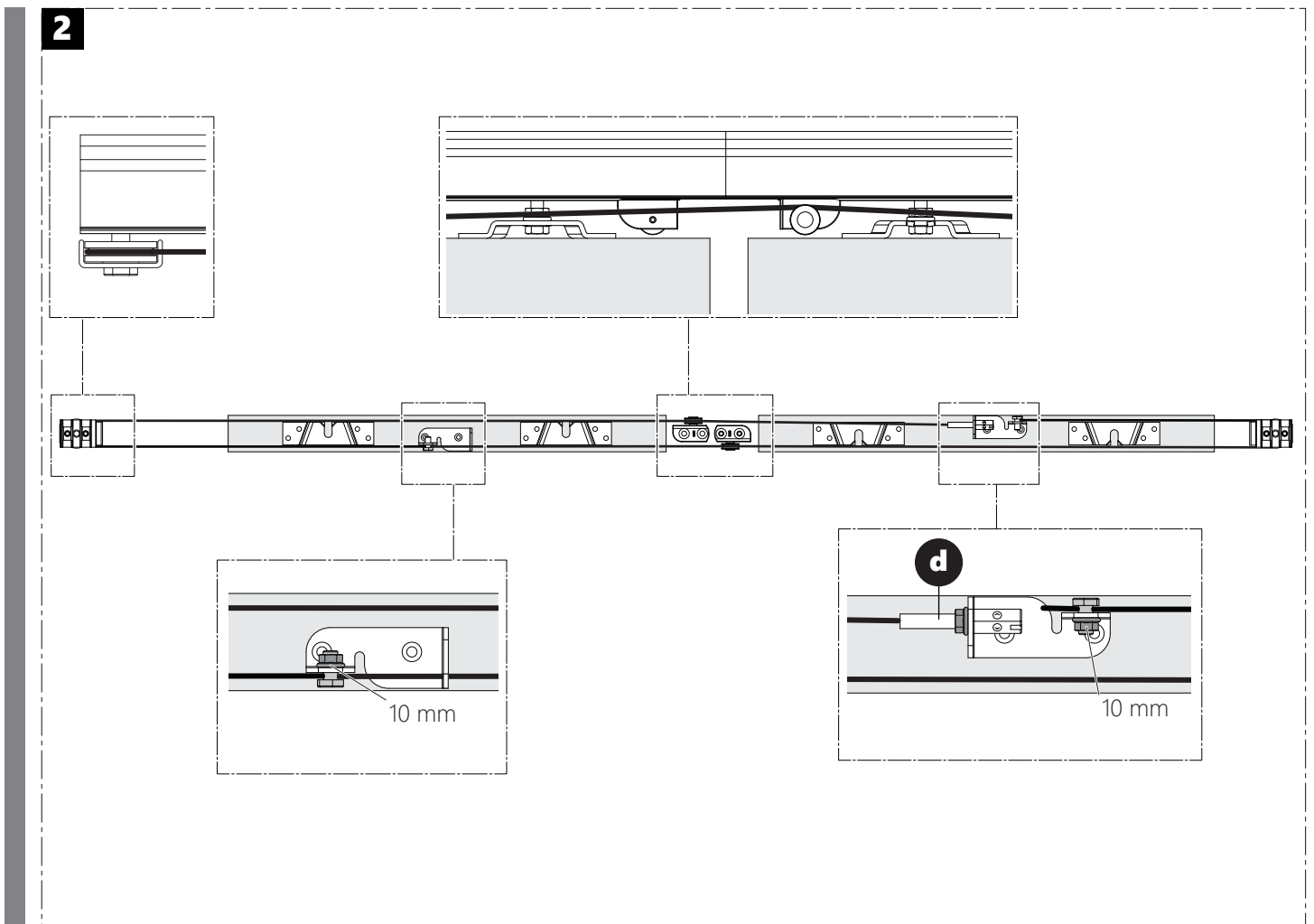
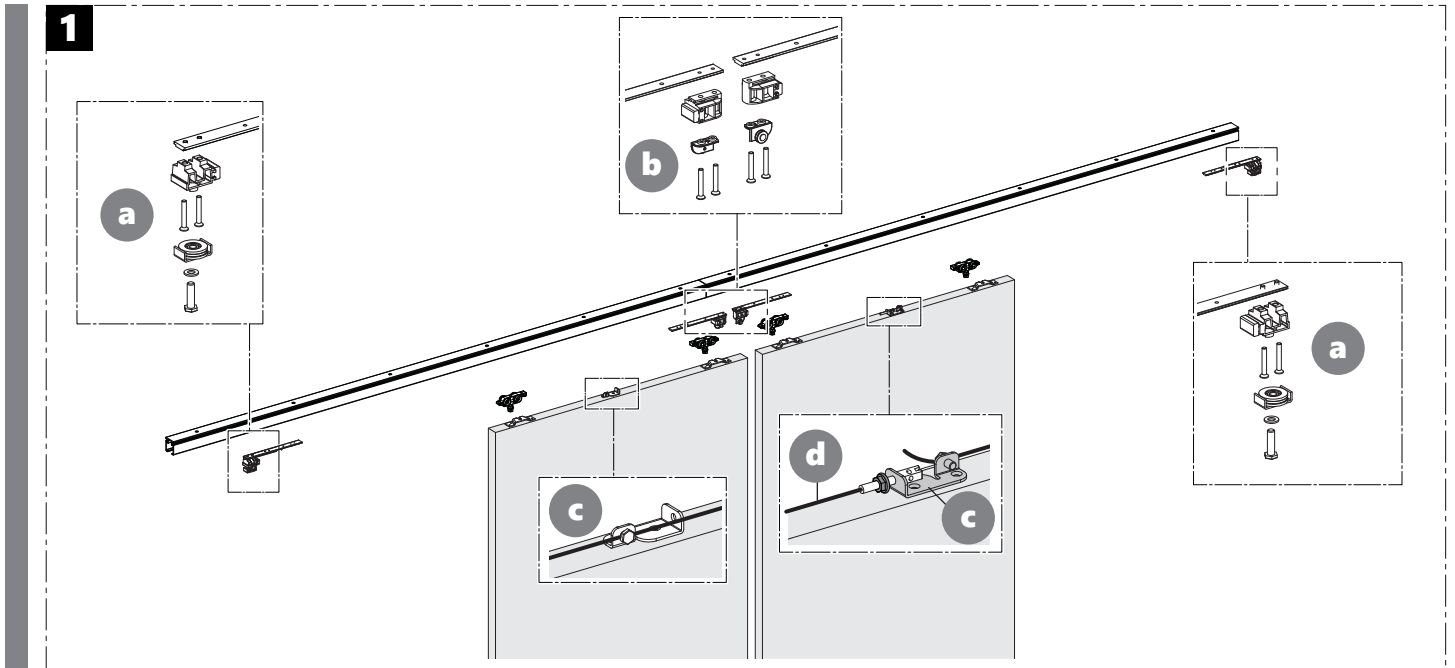

# INSTALLATION INSTRUCTION

SLIDING DOOR HARDWARE *HERRAJES PARA PUERTAS CORREDERAS*